

BOSSARD

Proven Productivity

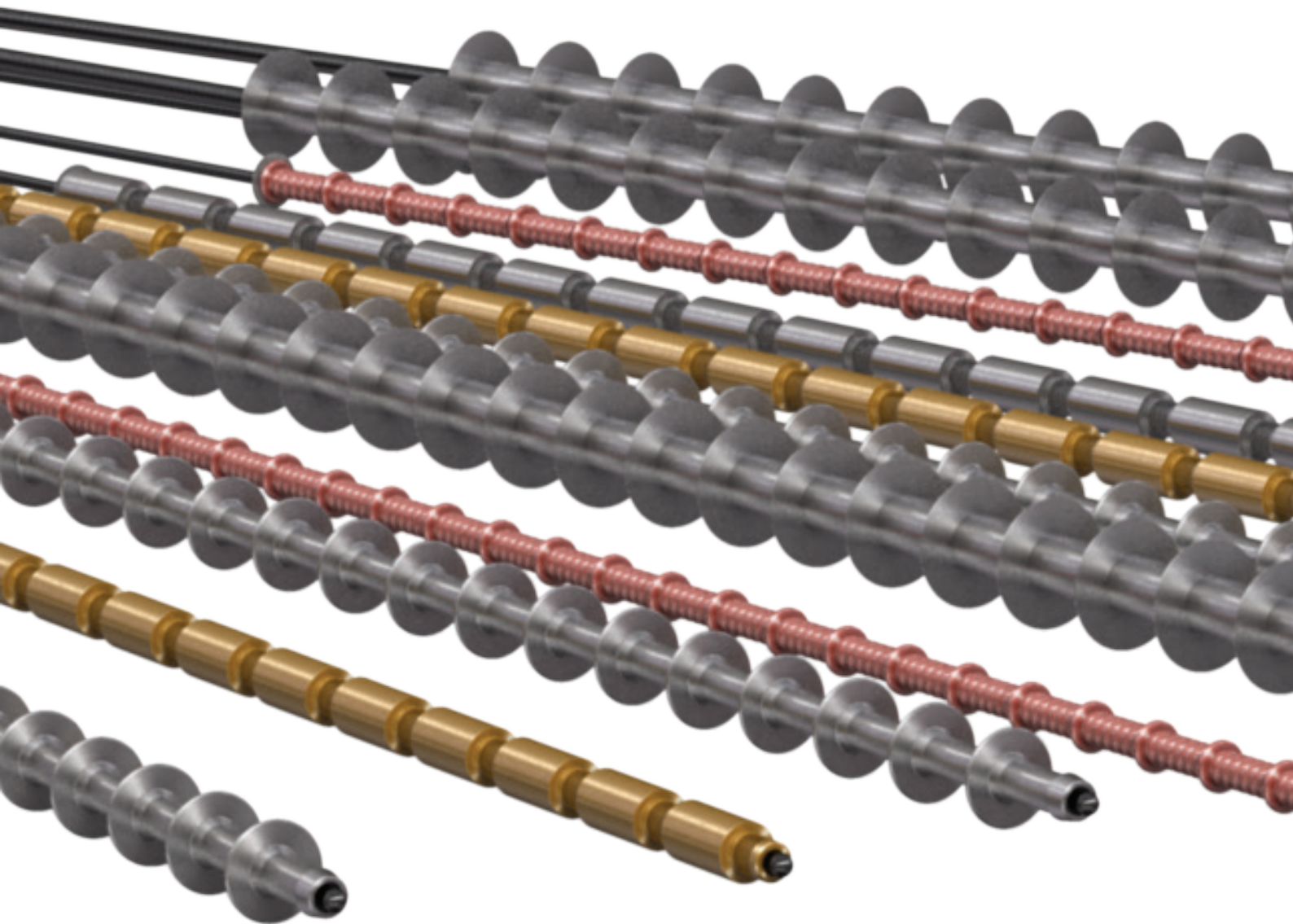

Speed rivets

FASTEKS[®] rivet technology

FASTEKS® speed rivets

FASTEKS® speed rivets are preloaded on the riveting mandrel. This makes FASTEKS® speed rivets unique.

The speed rivets are pre-loaded on the riveting mandrel. This way the safety of the process is always guaranteed (no determination of the appropriate mandrel and checking mandrel wear, thanks to single-use mandrel).

Characteristics

- Rapid processing (up to 70 rivets per minute)
- Cost-saving
- Weight-saving
- Variety of materials
- No breakstem
- No waste

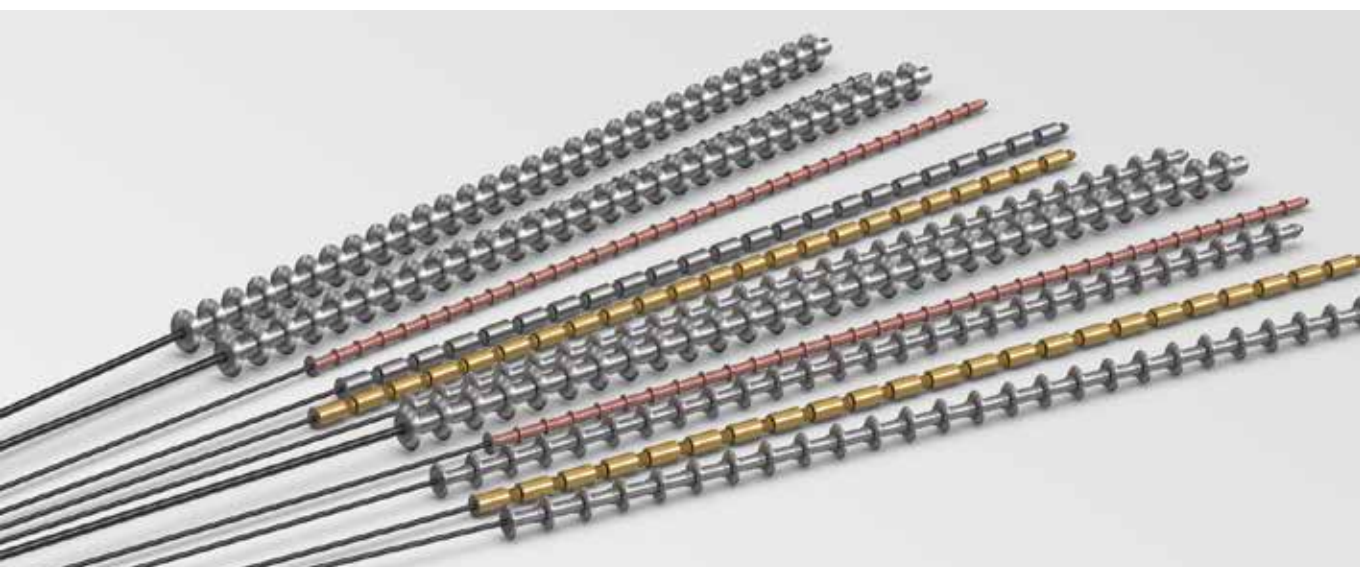

Standard speed rivets

FASTEKS® standard speed rivet achieves a high clamping strength thanks to the formation of its closing head.

Setting process / operating principle

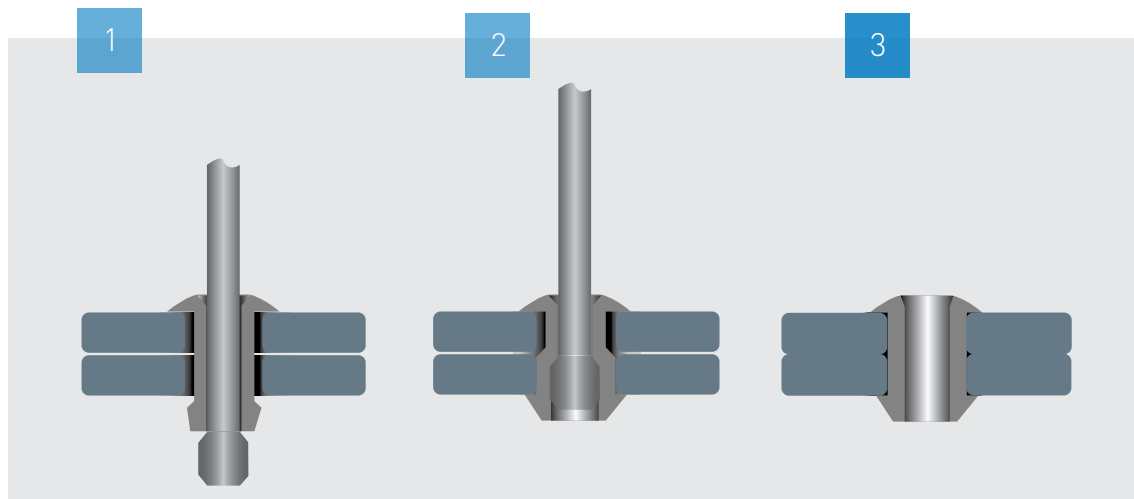

fasteks

Dome head

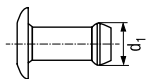

Countersunk head

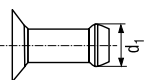

Typ	Name	Materials			d ₁ from / to	Grip range from / to
Standard	Dome head	Aluminum	Steel	stainless steel	Ø 3.2 - 4.8	1.1 - 10 mm
Standard	Countersunk head	Aluminum	Steel	stainless steel	Ø 3.2	1.5 - 6.8 mm

Multi speed rivets

FASTEKS® Multi speed rivet has a high grip range.

Setting process / operating principle

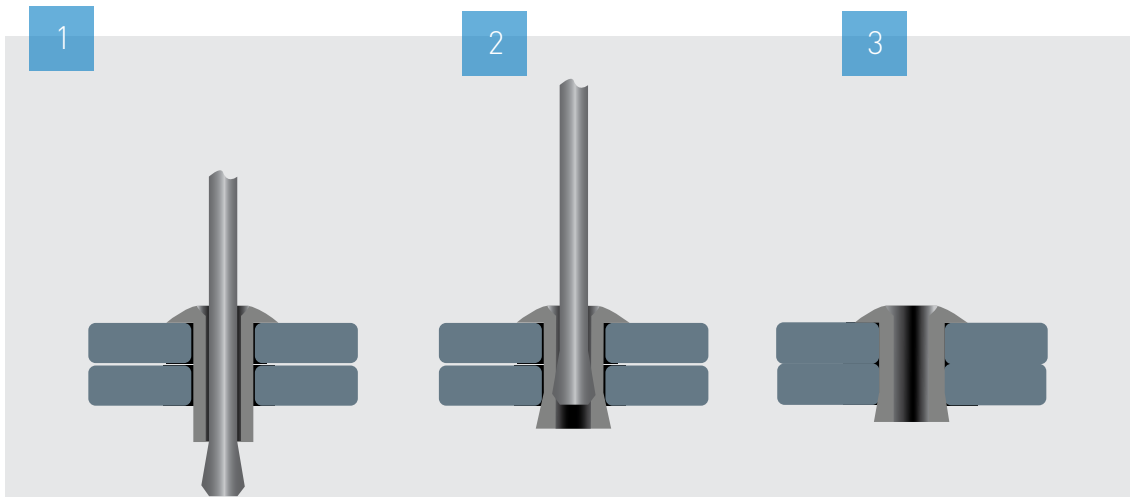

fasteks

Dome head



Countersunk head

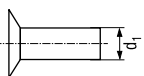

Typ	Name	Materials			d ₁ from / to	Grip range from / to
Multi	Dome head	Aluminum	Steel	stainless steel	Ø 1.9 - 4.8	1.0 - 11 mm
Multi	Countersunk head	Aluminum	Steel		Ø 3.0 - 4.8	1.0 - 12 mm

Grooved speed rivets

FASTEKS® Grooved speed rivet suitable for electronic components or soft materials.

Setting process / operating principle

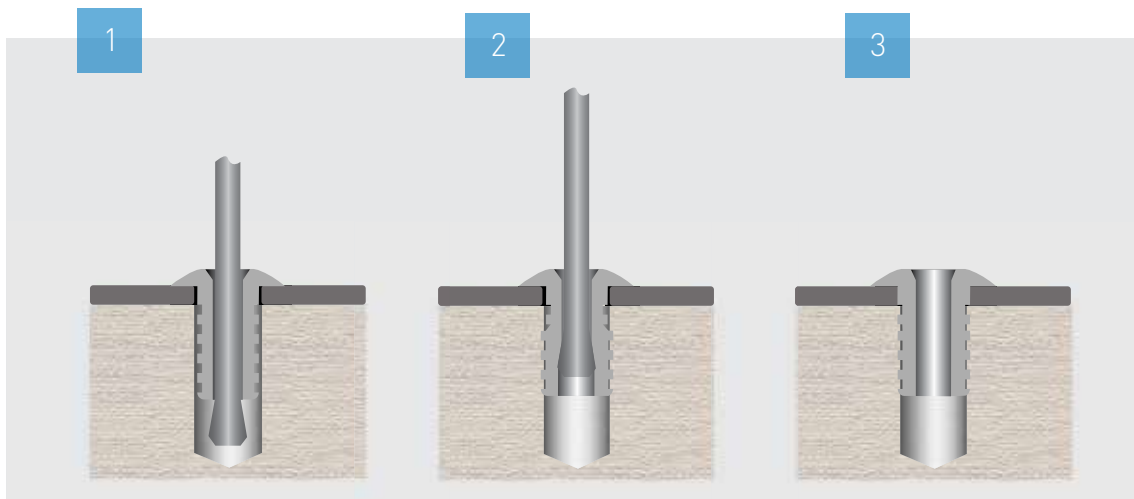

fasteks

Dome head

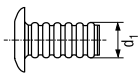

Typ	Name	Materials		d ₁ from / to	Grip range from / to
Grooved	Dome head	Aluminum	Brass	Ø 1.7 - 2.6	1.1 - 9 mm

(Copper on request)

Screw speed rivets

FASTEKS® screw speed rivet with thread. (countersunk head is transformed into flat head in the riveting process).

Setting process / operating principle

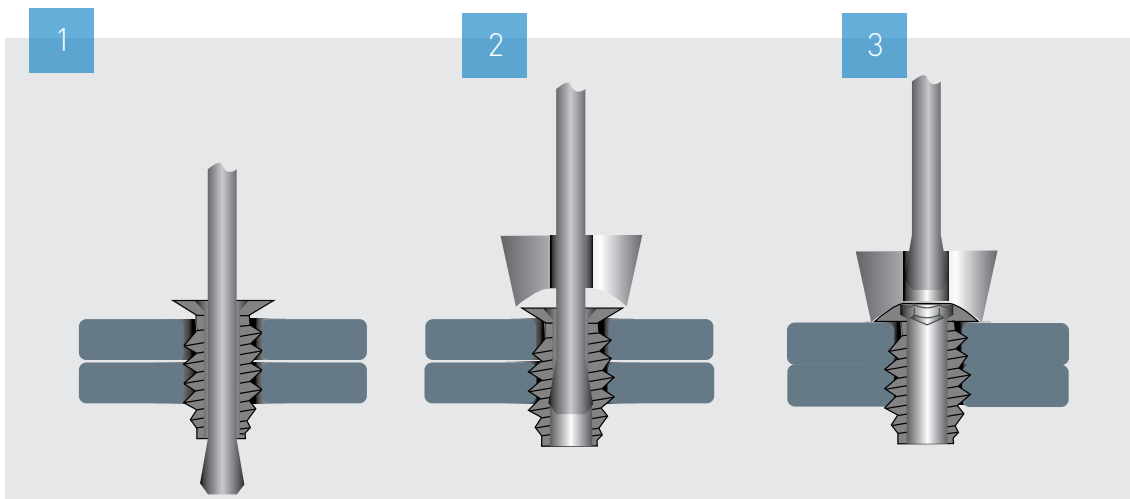

fasteks

Dome head after riveting process

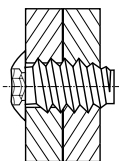
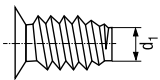

Typ	Name	Materials	d_1 from / to	Grip range from / to
Screw	Dome head	Steel	Ø 2.7 - 3.5	1.6 - 7.8 mm

Space speed rivets

FASTEKS® space speed rivet can be used as a spacer on printed circuit boards (board thickness 0.8mm - 2.4mm).

Setting process / operating principle

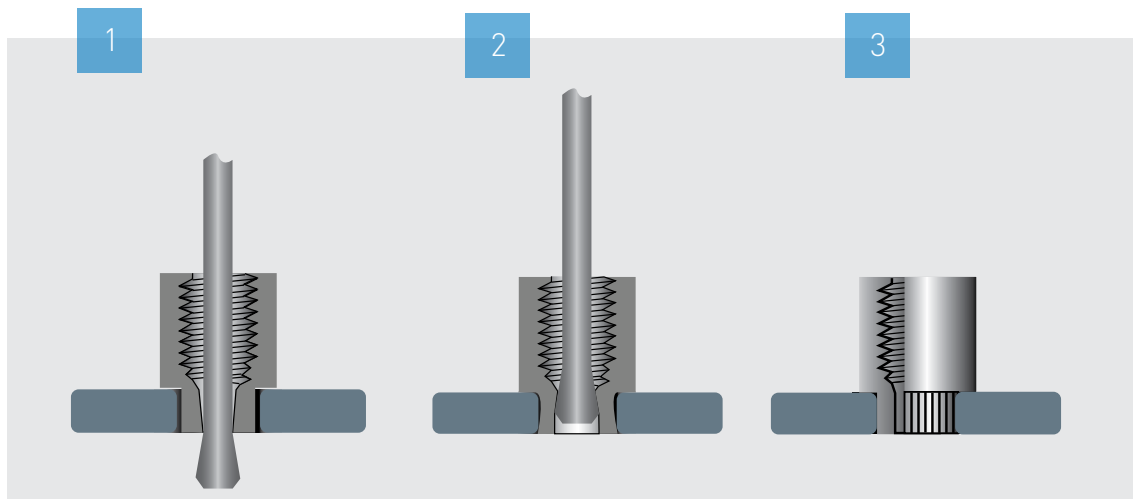

fasteks

Spacer

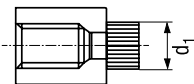

Typ	Name	Materials	d_1 from / to	Grip range from / to
Space	Stand off	Brass	Ø 2.5 - 3.2	0.8- 2.4 mm



Bossard Group
Steinhauserstrasse 70
P.O. BOX 1257
CH-6301 Zug

Phone +41 41 749 66 11
Fax +41 41 749 66 22

www.bossard.com